

***Stocks*AG**

Rotor Jet 130 and 240 – i-CON

ORIGINAL OPERATING MANUAL & PARTS LIST

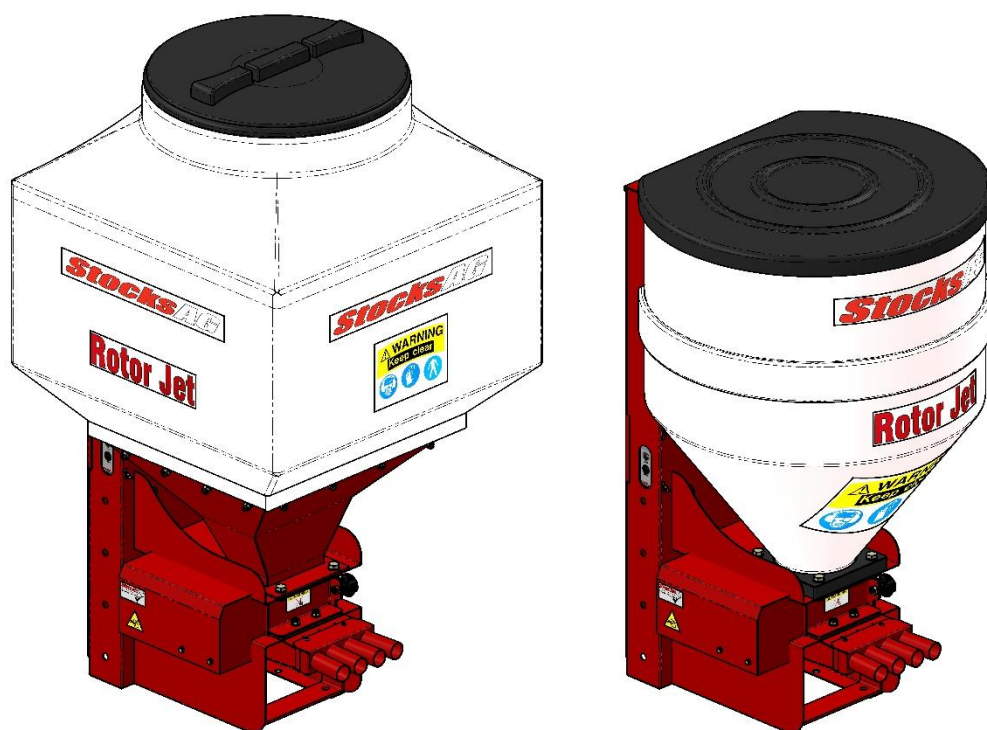

Read carefully before installation and operation

This document must not be copied, duplicated or distributed without prior consent.
All intellectual property and patent rights apply.

Stocks Ag Limited.

Cromwell Road, Wisbech, Cambridgeshires, PE14 0SD, UK
01945 464909 sales@stocks-ag.co.uk www.stocks-ag.co.uk



TABLE OF CONTENTS

Section		Page
	E.C. DECLARATION OF CONFORMITY	4
	UKCA. DECLARATION OF CONFORMITY	5
1.0	General Information	6
1.1	Technical Data	6
1.2	Intended Use	6
1.3	Unintended Use	6
1.4	Machine Identification	7
1.5	Warranty	7
2.0	Safety	8
2.1	Safety Decals	10
3.0	Emergency Stop Instructions	11
4.0	Storage	11
5.0	PVC Waterproof Covers	11
6.0	Disposal	12
7.0	General Maintenance	12
7.1	Before use	12
7.2	Daily Checks	12
7.3	After Each Use	13
8.0	Installation Guide	14
8.1	Base Plate	15
8.2	Spreader Plates	15
8.3	Spreader Plate Set Up	16
8.4	"C" Section Rail	18
8.5	Feed Hose	18
9.0	Machine Components	19
9.1	Feed Motor	19
9.2	12v Fan Unit	19

9.3	GPS Sensor	19
9.4	Main Power Cable	19
9.5	Instrument Lead	19
9.6	Spring Finger Switch	20
9.7	Hopper Level Sensor	20
10.0	Inspection	21
10.1	12v Fan Inspection	21
10.2	Feed Block Assembly Inspection	21
11.0	Hopper Emptying Procedure	22
12.0	Clearing a Feed Hose Blockage	23
13.0	Checking the Feed Motor	23
14.0	i-CON Control System	24
14.1	Wiring Diagram	24
14.2	Electrical Connections	24
14.3	i-CON Instrument Functions	25
14.4	Precision Farming Software – Optional	25
15.0	i-CON Calibration	26
15.1	On the Machine	26
15.2	On the i-CON Instrument	26
15.3	Manual Calibration	27
15.4	GPS Speed	27
15.5	Common Calibration Mistakes	28
15.6	Ready For Work	28
15.7	Setting the Feed Rate	28
15.8	Run Hold/Cut Out Switch	29
15.9	Hopper Level Sensor	29
16.0	Feed Block Kit Information	30
16.1	Standard Large Seed Feed Block Kit – 50mm	30
16.2	High Capacity Feed Block Kit – 59mm	30
16.3	Precision Small Seed Feed Block Kit	31
16.4	Granular Feed Kit	32

17.0	Ready for Work	33
18.0	i-CON Control System – Drawing and Parts	34
19.0	Rotor Jet 130 Parts Drawing	35
19.1	Rotor Jet 130 Parts List	36
20.0	Rotor Jet 240 Parts Drawing	37
20.1	Rotor Jet 240 Parts List	38
21.0	Granular Feed Roller - Parts	39
22.0	Precision (Small Seed) Feed Roller – Parts	40
23.0	Large Seed Feed Roller – Parts	41
24.0	High-Capacity Feed Block – Parts	42



E.C. DECLARATION OF CONFORMITY

Machine Type: Mounted Agricultural Implement - Pellet and Seed application broadcasters

Model(s):	Fan Jet Pro	All Variants and Versions
	Fan Jet Plus	All Variants and Versions
	Fan Jet Mini	All Variants and Versions
	Fan Jet Duo	All Variants and Versions
	Maxi Jet	All Variants and Versions
	Turbo Jet	All Variants and Versions
	Rotor Meter	All Variants and Versions
	Rotor Jet	All Variants and Versions
	Micro Meter	All Variants and Versions
	Maxi Meter	All Variants and Versions

Serial No.

Manufacturer: Stocks Ag Ltd
Cromwell Road
Wisbech
Cambridgeshire PE14 0SD
United Kingdom

This is to declare that the above machine conforms to the relevant Essential Health and Safety Requirements of the Machinery Directive 2006/42/EC, implemented in the United Kingdom by Statutory Instrument 2008 No. 1597 – The Supply of Machinery (Safety) Regulations 2008 as amended.

The following standards have been applied in the design and construction of this machine:

BS EN ISO 12100:	2010	Safety of machinery – General principles for design – Risk assessment and Risk reduction.
BS EN ISO 4254-1:	2015	Agricultural machinery – Safety - General requirements.
BS EN ISO 4254-8:	2018	Agricultural machinery. Safety - Solid fertiliser distributors.
BS EN ISO 13854:	2019	Safety of machinery – Minimum gaps to avoid crushing of parts of the human body.
BS EN ISO 13857:	2019	Safety of machinery – Safety distances to prevent hazard zones being reached by the upper and lower limbs.

The manufacturer stated above holds the technical file for this machine.

Signed on behalf of Stocks Ag Ltd

Name: J Woolway

Date: 06th August 2020

Position: Managing Director

t. +44 (0) 1945 464309 f. +44 (0) 1945 464385 e. sales@stocks-ag.co.uk



**UKCA. DECLARATION OF CONFORMITY**

Machine Type: Mounted Agricultural Implement - Pellet and Seed application broadcasters

Model(s):	Fan Jet Pro	All Variants and Versions
	Fan Jet Plus	All Variants and Versions
	Fan Jet Mini	All Variants and Versions
	Fan Jet Duo	All Variants and Versions
	Maxi Jet	All Variants and Versions
	Turbo Jet	All Variants and Versions
	Rotor Meter	All Variants and Versions
	Rotor Jet	All Variants and Versions
	Micro Meter	All Variants and Versions
	Maxi Meter	All Variants and Versions

Serial No.

Manufacturer: Stocks Ag Ltd
Cromwell Road
Wisbech
Cambridgeshire PE14 0SD
United Kingdom

This is to declare that the above machine conforms to the relevant Essential Health and Safety Requirements of the Machinery Directive 2006/42/EC, implemented in the United Kingdom by Statutory Instrument 2008 No. 1597 – The Supply of Machinery (Safety) Regulations 2008 as amended.

The following standards have been applied in the design and construction of this machine:

BS EN ISO 12100:	2010	Safety of machinery – General principles for design – Risk assessment and Risk reduction.
BS EN ISO 4254-1:	2015	Agricultural machinery – Safety - General requirements.
BS EN ISO 4254-8:	2018	Agricultural machinery. Safety - Solid fertiliser distributors
BS EN ISO 13854:	2019	Safety of machinery – Minimum gaps to avoid crushing of parts of the human body.
BS EN ISO 13857:	2019	Safety of machinery – Safety distances to prevent hazard zones being reached by the upper and lower limbs.

The manufacturer stated above holds the technical file for this machine.

Signed on behalf of Stocks Ag Ltd

Name:  J Woolway

Date: 01st December 2020

Position: Managing Director

t. +44 (0) 1945 464909 f. +44 (0) 1945 464985 e. sales@stocks-ag.co.uk



1.0 General Information

Congratulations on your Rotor Jet purchase.

Please check the machine for any transport damage upon receipt and advise your supplier of any problems immediately. Late claims regarding any damage may be rejected.

Specifications, descriptions and illustrations in this manual are accurate at the time of publication but may be subject to change. This manual is correct at the time of printing but Stocks Ag reserve the right to change and improve them. This machine is designed with safety in mind. Maintenance and servicing in accordance with this manual will ensure safe operation and reliability of your machine for many years.

This Operating Manual forms part of the machine and must be readily available for the operator who must read and follow the points covered before use.

1.1 Technical Data

Model: Rotor Jet 4 i-CON

Power requirement: 25 amps

Hopper capacity: 130 litre or 240 litre

Motor output: 360 watt

Max spreading width 12v fan: RJ - 4 outlets 3m
RJ - 8 outlets 4m

Noise level: 60dB Electric Fan

Operating voltage: 12v

Power consumption of the motor: 25 amps when starting, up to 20 amps during normal operation

130 litre machine:

Net weight: 42kg with spreader kit 52kg

Dimensions: 66 x 100 x 116cm

240 litre machine:

Net weight: 50kg with spreader kit 65kg

Dimensions: 70 x 110 x 143cm

1.2 Intended Use

This Rotor Jet has been designed solely to apply small seed and granular products for use in the agricultural, horticulture and the amenity sectors.

Any other use is considered to be non-intended and the manufacturer will not be liable for any resulting damage.

The manufacturer is not liable for any resulting damage if the machine is used for any other purpose than the intended use and also includes compliance with the conditions for operation, maintenance and repairs prescribed within this instruction manual.

NOTE: Do not use this machine during adverse weather conditions.

The applicable accident prevention regulations as well as the other generally safety-related, occupational health and road traffic regulations must also be observed.

1.3 Unintended Use

This machine is not designed to apply abrasive materials such as sand and grit or for applying salt products.

The operator alone bears the associated risk if used for non-intended use.

1.4 Machine Identification

Example Decal Only



The machine can be identified by the serial number decal mounted on the steel chassis to the left of the feed cassette.

1.5 Warranty

We provide a 12 month warranty from the date of invoice (the invoice for the machine will serve as a warranty certificate).

This warranty is applicable for cases of material or construction faults and does not include parts that are damaged by normal or excessive wear.

Warranty expires if damage is caused by external forces, operator error, modifications, jet washing or if the machine has been used for unintended use.

In the event of any problems, or before attempting any repair, please contact the company from where the machine was purchased. If the base machine or the controls system are modified in any way this will void any warranty claim.

Stocks Ag cannot be held responsible for any claims or injuries to the owner or any third parties while in the operation of Stocks Ag equipment.

On no account can Stocks Ag be held liable for accidental or consequential damages (including loss on anticipated profits) for any impairment due to failure or defect of the machine.

Please see our conditions of sale for full details, a copy of which available upon request.

Please record the machine serial number here:

S/N

Purchase date:

Dealer

2.0 Safety

Ensure care is taken when lifting the machine.

Safe lifting practice to be observed when handling as the net weight is over 25kg.



We advise safety shoes and protective gloves are worn when handling the machine.

Assistance will be required when lifting or lowering the machine.

Care to be taken to avoid crushing due to the weight of the machine.

When lifting or fitting the machine on to a parent vehicle or implement ensure work is performed on level ground or flat surface to avoid slipping, stumbling or falling.

PERSONAL PROTECTION EQUIPMENT

It is the responsibility of the operator or maintenance engineer to ensure safe handling of the machine and the appropriate personal protection equipment must be worn for the material being applied and to prevent contamination to the machine or the environment.

 **WARNING! Ear protection required if working in close proximity to the machine as it exceeds 60dB.**

PRODUCT APPLIED

If applying slug pellets or other toxic material and the parent vehicle has a closed cab the operator must ensure the cabin is always closed and the air filter system is in good order. If fitted to a UTV vehicle ensure the stability of the parent vehicle is not affected when the machine is in use. If in doubt contact the vehicle manufacturer for more information. After working the machine ensure that any unused product is returned safely to its original packaging. Stocks Ag Ltd. does not accept any liability for the storage and use of the material being applied.

NOTE: If unsure contact your seed or product supplier for more information.

 **WARNING! Always observe all application standards and guidelines provided by the product manufacturer as some seed dressings and granular products may be toxic.**

OPERATION AND MAINTENANCE

The machine may only be used, maintained and repaired by persons who have relevant experience or a machinery dealer who is aware of any risks involved. The applicable accident prevention regulations as well as the other generally safety related, occupational health and road traffic regulations must also be observed.

The manufacturer is not liable for any damage resulting from unauthorised modifications and the use of components and auxiliary parts. The machine must be checked regularly by the operator (before each use) for any damage, loose bolts or electrical connections, vibrations, unusual sounds, to ensure it functions correctly.

2.0 Safety Continued

The machine must not be operated in wet weather conditions or during thunderstorms. Observe the generally applicable safety and accident prevention regulations. Always empty the hopper of toxic materials to prevent harm to humans and animals after each use and prior to storage.

 **WARNING! Do not put your hands inside the hopper when the agitator motor is turning as the agitator shaft inside the hopper rotates at high speed and is sharp and dangerous.**

 **WARNING! Always isolate the power supply if servicing or leaving the machine unattended.**

2.1 Safety Decals



WARNING!

Read and understand the Operators Manual instructions before operating this machine.

Operator errors can result in serious injury.



WARNING!

Danger due to thrown or flying objects. Always maintain a safe distance whilst the machine is in operation.



WARNING!

Risk of injury. Possible trapping point when tipping hopper.



WARNING!

Risk of injury. Be aware the feed mechanism is powerful and can cause serious injury.



WARNING!

Keep Clear!

Maintain a safe distance from the machine when in operation.

Wear the appropriate protective personal equipment.



WARNING!

Do Not Jet Wash. This machine is not designed to withstand jet washing.

3.0 Emergency Stop Instructions

In the case of an emergency always switch off the main power switch on the control panel and isolate the power supply immediately by disconnecting the power cable.

1. Power down the control system immediately by pressing and holding down the left-hand rubber end cap on the instrument control panel for approx. 2 seconds — then release to power off.
2. Disconnect the power supply by unplugging the power cable or removing the fuse.

"POWER OFF" SWITCH
POSITION



4.0 Storage

Disconnect the power supply by unplugging the power cable or by removing the fuse fitted in the power cable.

It is the responsibility of the operator to ensure the hopper is empty after use and cleaned thoroughly before storage.

Store in dry conditions to protect the machine and control system from moisture.

Always clean and spray electrical connectors with a moisture repellent spray when not in use for long periods.

Fit the PVC waterproof cover (if available).

Ensure feed blocks are free to turn and all electrical cables checked following periods of storage.

5.0 PVC Waterproof Covers

Heavy duty white PVC covers fitted with eyelets and bungie cord for easy attachment.

Please contact your local Stocks Ag dealer for more information

6.0 Disposal

Ensure that any persons handling the machine are aware that the machine may have been used to apply toxic chemicals and so the appropriate personal protection equipment should be worn.

Ensure the hopper contents and any toxic residue have been removed and put back into a sealed container or disposed of in accordance with the manufacturers guidelines to eliminate any possible contamination of others or the environment.

Always adhere to the local disposal regulations paying particular attention to the plastics, rubber and electrical components.

7.0 General Maintenance

Ensure the parent machine is stationary and parked on level ground before working on the machine.

The machine must be checked regularly by the operator for any damage, loose bolts or electrical connections, vibrations, unusual sounds, to ensure it functions correctly.

 **WARNING! Always ensure the power supply is disconnected before any maintenance work or cleaning of this machine by unplugging the power cable or removing the fuse in the power cable.**

Always observe all guidelines provided by the product manufacturer with regards to handling, storage and disposal of products.

Take care not to spill any product that could contaminate the machine or the environment, ensuring any product removed from the machine is put back into its original container.

 **WARNING! Protective clothing must be worn when applying or handling toxic products.**

7.1 Before use

1. Ensure the machine is securely mounted.
2. Check the power supply and ensure the power cable is connected directly to the vehicle battery.
3. Check the feed block is configured correctly and free running before starting work.

7.2 Daily Checks

1. Check the feed motor and agitator motors are working correctly.
2. Check the 12v fan and air intake meshes are clean and free from any debris.
3. Check feed hoses for any blockages and all hose clips are tight.
4. Check the spreader plates are positioned correctly

7.3 After Each Use

1. Empty hopper and clean the machine thoroughly.
2. Disconnect the power supply.
3. Replace the PVC waterproof cover (if applicable).
4. Store in dry conditions to protect the machine and control system from moisture.

WARNING!

DO NOT JET WASH THIS MACHINE



8.0 Installation Guide

The Rotor Jet can be used for a wide variety of seeding applications in conjunction with a wide variety of parent implements.

It is not practical to supply tailored mounting brackets for every implement on the market, and so the final attachment of the Rotor Jet to the implement is the responsibility of the supplying dealer or end user.

The positioning of the hopper, the spreader plate and "C" section mounting rails, if used, will depend upon the type and design of host implement. Here are a few basic pointers to ensure the Rotor Jet performs correctly.

Position the Rotor Jet high enough above the implement to facilitate routing of the flexible tubes, to the spreader plates, without severe bends or uphill runs. Try to route all tubes generally downhill. Do not block the air intake to the fans under the base plate.

If mounting on a folding implement, ensure the wing sections do not foul the hopper and all hose runs are long enough to fold with the implement.

Ensure you can access the hopper to fill, are able to remove the feed block assembly and position the calibration tray underneath to calibrate or empty.

When filling, emptying or calibrating the Rotor Jet ensure you work safely. If necessary, fabricate and fit a work platform and steps, complete with handrails. The hopper may face forwards or backwards, whichever offers the easiest mounting and best flexible hose run. Select a strong, rigid position and use the heavy flat base plate provided to weld or bolt to your implement as per the following example.



8.1 Base Plate

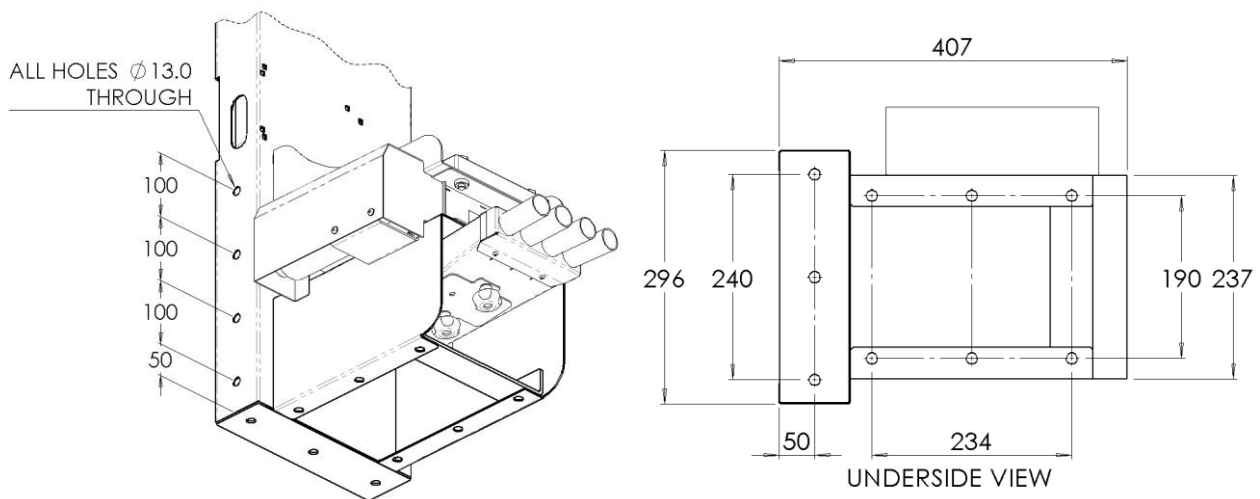

8.2 Spreader Plates

The machine has 4 outlets, if required the feed hoses can be split with the black "Y" connectors in the relevant kits, to give 8 spreader plates. This depends on the implement width and if you require a broadcast or band sown effect.

Plan the positioning of the pipes/spreader plates to be equal distance across the width of your implement. If using the black plastic "Y" connectors ensure they are fitted above the spreader plate using as short a run of flexible hose to the plates as possible, whilst still providing a smooth flow and being of equal length. It is recommended that a straight of a minimum 300mm section of pipe is utilised prior to the "Y" connector, to ensure a more even split of product. Flexible hoses from the connectors run to the outlet pipes on the Rotor Jet. Aim to route all hoses smoothly and generally downhill from the hopper to the spreader plate, avoiding severe bends and uphill runs.

8.3 Spreader Plate Set Up

The Stocks Ag spreader plate was developed to allow a wider spread pattern while positioning the outlets closer to the ground.

For products such as grass seed, oil seed rape and Avadex, a spread width per outlet of 750mm is achievable from as low as 250mm above the ground (air flow dependent).

A 3m grass harrow only requires 4 evenly spaced outlets. With the addition of the "Y" pieces a max spread width of 4m is achievable.

The spreader plates have two main adjustments to set up the optimum spread pattern to suit a variety of products and machine fitments.

The main bottom plate requires bending into position. The angle of the bottom plate alters the spread width from each outlet. A common setup would be to bend from vertical to approximately 30mm at the opening (see below).



8.3 Spreader Plate Set Up Continued

There are two adjustable tabs on the back plate of each outlet. These tabs are used to create an even arc shaped spread pattern and when required, to adjust overlap between outlets.

When the back plate is left straight, some products can produce a spread pattern similar to the diagram below.

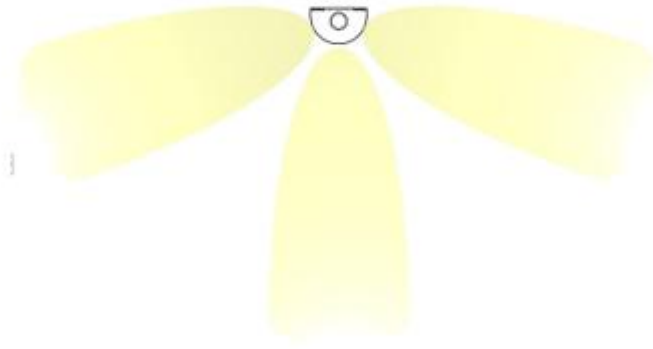

By bending the back plate tabs in slightly (see diagram below).

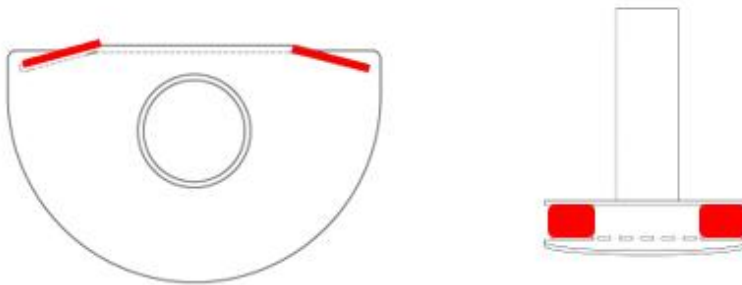

The coverage of the product over the ground can be made much more uniform.



These recommended settings are an initial guide; set up may vary between different products and machine fitments and require further adjustment.

8.4 “C” Section Rail

The spreader plates themselves are mounted to the “C” section rails, these can be ordered in 2m lengths as an option. Part no. **47TJT5008**. These can be cut down to suit the implement width. The “C” section rails can be attached to the implement using the supplied straight brackets, two per rail, which can be welded or bolted into position.

The spreader plates slide along the rails to give the planned spacing and lock into position using the integral bolts. It is generally better to position the spreader plates facing the rear of the implement as this can prevent wet mud or tilth being thrown up into the mouth of the spreader causing blockages, especially if positioned close behind the tractor wheels, roller or discs.

8.5 Feed Hose

The feed hose comes in lengths of 4m for the 4 outlet and 8m for the 8 outlet kits, to be ordered as an option with a new machine. Extra feed hose can be ordered by the metre as a spare part. This requires cutting into lengths according to the positioning of the hopper and spreader. Ensure all hose runs are as short as possible whilst giving a smooth downhill route to the spreader plates. Avoid kinks, severe bends or uphill runs. Plan and measure the individual hose runs before cutting, fit the hose clips to the “Y” connector tails.



9.0 Machine Components

9.1 Feed Motor

The feed motor can be turned ON or OFF, either manually via the head unit, or through the remote mounted spring-type finger switch, which can be fitted to the linkage or the implement.

9.2 12v Fan Unit

The single 12v electric fan is mounted on the rear of the outlet manifold, at the bottom of the machine.

The fan ON/OFF switch is mounted on the side of the machine.

NOTE: Turn the fan **OFF** when calibrating, and **ON** once calibrated and ready for work.

9.3 GPS Sensor

Small and compact with integrated magnetic base for ease of fitting to tractor cab or suitable mounting position. Fitted with a 5m lead which plugs into the i-CON instrument connector cable.

9.4 Main Power Cable

The power cable should connect directly to the vehicle battery posts to ensure adequate 12v supply to the disc motor. The in-line is 25 amp. This 7m power cable connects the battery to the power input flylead on the machine.

9.5 Instrument Lead

The 6m instrument lead connects to the junction box of the Rotor Jet and runs to the control panel in the tractor cab.

NOTE: Extension power and instrument cables are available, if required.

Please contact your local Stocks AG dealer for more information.

9.6 Spring Finger Switch

The switch should be mounted to a suitable place on the implement or linkage of the tractor. Deflecting the spring automatically switches the feed motor off or on accordingly as the circuit is made or broken.

Position the finger switch so that the tip of the spring comes into contact with the moving part of the implement or linkage when lifted out of work, and remains deflected, until the implement is lowered back into work.

NOTE. Ensure that there is sufficient and positive deflection on the spring to prevent accidental switching ON or OFF if the implement moves slightly up or down in work.

The standard wiring supplied for this switch is when the spring is at rest, the feed motor will be off. If required, the switch can work in the opposite mode by changing the position of the 2 wires inside the switch so that the switch is out of work when the spring is at rest. To alter, remove the PVC cover plate held in position with the retaining screw to access the wiring terminals. Remove the 2 wires from terminals 13 and 14 and re-connect to terminals 21 and 22 (nearest the gland nut) then re-fit the PVC cover plate.

NOTE: The area meter also stops when the feed motor stops.

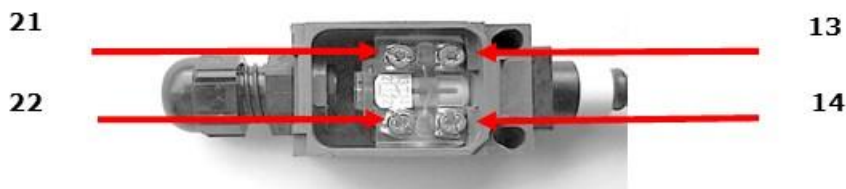

9.7 Hopper Level Sensor

The instrument will alarm once the product in the hopper falls below the level of the sensor.

10.0 Inspection

10.1 12v Fan Inspection

⚠ WARNING! Always isolate the power before inspecting or servicing the machine.

To inspect the fan unit, look underneath the hose outlet manifold, the fan is bolted to the rear. Wearing appropriate PPE, use an airline and brush to clean the fan blades regularly to maintain performance and prevent eccentric running.

Always check the fan air intakes are clean and free from debris.



10.2 Feed Block Assembly Inspection

⚠ WARNING! Always observe all application standards and guidelines provided by the product manufacturer as some seed dressings and granular products may be toxic!

NOTE: If unsure contact your seed or product supplier for more information.

1. Empty the hopper completely to prevent spillage, unscrew the two threaded knobs and drop the cover under the feed rolls. Position the plastic collection tray directly underneath to catch any remaining seed or product.
2. Undo and remove the 2 black plastic knobs holding the mechanism in place and slide out the feed block assembly.

Be aware that the feed block assembly may retain some seed product.

3. Use an airline and brush to clean the feed block and internal components checking for any wear or damage. Replacing any worn or damaged parts as necessary. When doing this wear appropriate PPE.
4. Before re-fitting the feed block ensure the feed shaft can be easily turned by hand using the black PVC knob fitted to the end of the shaft. If it is difficult to turn remove the end cap at the opposite end of the feed block assembly and remove all spacers and feed rollers by sliding each one off the shaft.
5. Check the drive shaft engages correctly when sliding the feed block back into the machine by slowly rotating the central black plastic knob before re-fitting the outer black plastic retaining knobs.



11.0 Hopper Emptying Procedure

The i-CON control box has an empty function (see separate i-CON manual). This function can be used to meter product out through the calibration cover into a suitable container. Any remaining product is best removed using an industrial vacuum before the feed block is removed from the machine.

Once the feed block has been removed from the machine dispose of any remaining product held in the feed block. Undo the bottom calibration door and check the air chambers for any sign of debris, or build up of product, and clear as necessary.



12.0 Clearing a Feed Hose Blockage

In the unlikely event of a blockage, remove the hose and clear any obstruction from within the hose or manifold on the machine. Remove the feed block and check the air chamber below the feed block opening and clear any debris. Re-position the feed hoses if this has been the cause of the problem.

⚠ WARNING Always observe all application standards and guidelines provided by the product manufacturer as some seed dressings and granular products may be toxic.

NOTE: If unsure contact your seed or product supplier for more information.

13.0 Checking the Feed Motor

Firstly, empty the hopper then remove the feed block assembly. Remove the motor guard by releasing the fixing screws.

Check to see if the feed motor shaft rotates using the empty function on the i-CON control box.

If the shaft is not rotating this may indicate the motor is faulty or has been damaged and needs to be replaced.

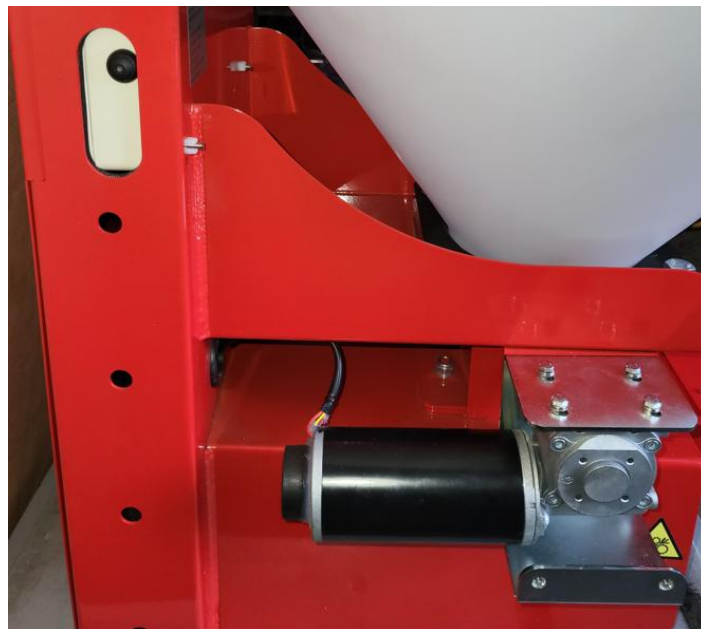

WARNING This procedure must be carried out by a competent person who is aware of any risks involved as moving parts of this machine are powerful and can cause injury.

For any parts or if no faults found and the alarm persists contact your local Stocks Ag dealer.

14.0 i-CON Control System

All control system components integral to the seed applicator unit are factory-fitted in.

The Instrument has a 4.3" colour touch screen which has 4 basic menu keys.

Separate heavy-duty power cable and head unit leads interconnect the tractor and the Seed Applicator Unit.

The following components need to be installed during fitment and are packed in the hopper from factory.

- i-CON Instrument: TJ117C
- Instrument Cables: TJ118C and TJ242A
- Power Cables: FJ107E
- GPS Receiver: TJ255B
- Cut out Switch: TJ252

14.1 Wiring Diagram

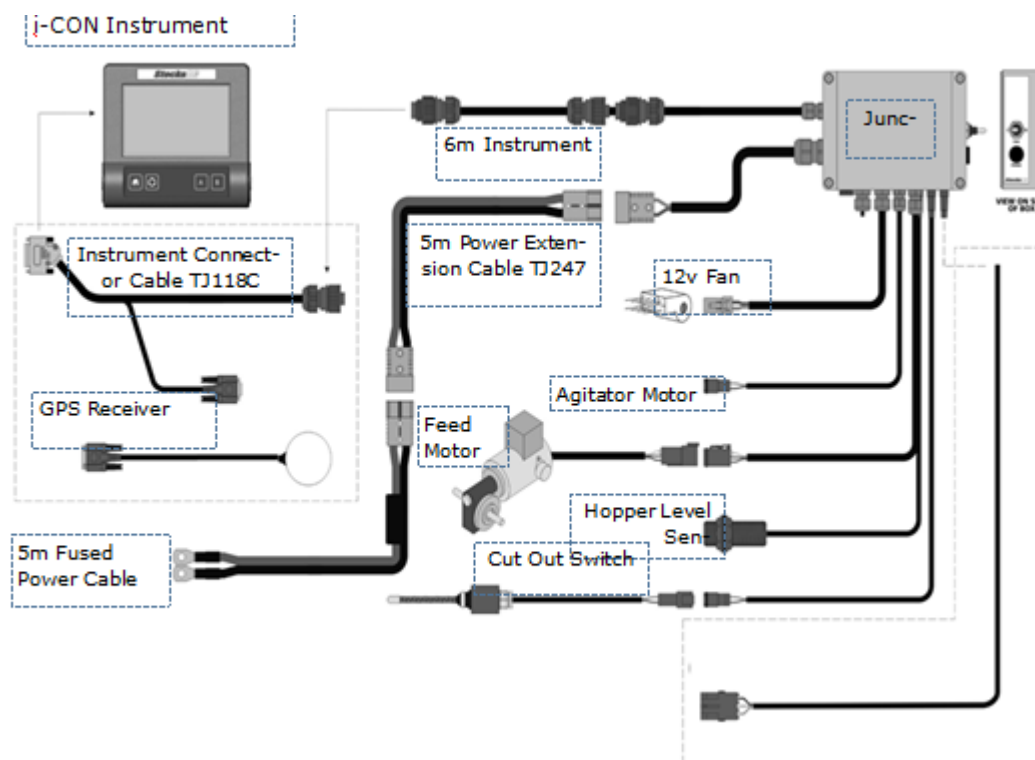

14.2 Electrical Connections

Ensure the power supply cable is connected directly to the vehicle battery to ensure maximum power.

Connect the positive wire (fused) to the positive (+) terminal and negative earth connection to the negative (-) terminal. The disc should rotate in a clockwise direction when viewed from above.

Failure to connect to the vehicle battery may result in control function problems and possible damage to the vehicle battery. The charging system must be in good condition to achieve the best results. All cables and controls are fitted with matching plugs and sockets. Extension cables available.

Any modification to the wiring, fuse holder or controls will invalidate any warranty claim and may affect the performance. Always replace any blown fuse with the same rated fuse as the original one fitted.

14.3 i-CON Instrument Functions



- Seed Application Rate (kg/ha or Seeds/m²).
- Forward Speed (km/hr).
- Minimum/Maximum Forward Speed indicator with alarms, (beyond which the programmed seed rate cannot be maintained).
- Metering Unit Status (On/Off) and Alarm.
- Fan (or Spinner - depending on installation) Status (On/Off) and Alarm.
- Hopper contents (kg) and Low Level Alarm.
- Part and Full (Job) Totals for Area (ha), Product dispensed (kg) and hours worked.
- Grand Total for Area (ha), Product (kg) and hours worked.
- **Other features include**
 - Simple and intuitive touchscreen Alarm codes and diagnostic displays in the event of system malfunction.
 - Menus for Forward Speed / Product calibration and adjustment.
 - Pre-start' - ensures seed delivery begins immediately the drill enters work (user-programmable).
 - Rate 'Nudge' - on-the-move rate adjustment in pre-set increments (user-programmable).

NOTE: A comprehensive control system user guide is also supplied (packed with the i-CON instrument).

14.4 Precision Farming Software – Optional

The instrument can be unlocked to activate the precision farming programme as a cost option.

This is something that can be requested when the machine is purchased or can be added at a later date.

Please contact your local Stocks Ag dealer for more details.

Rotor Jet 4 i-CON Operating Manual & Parts List P25







15.0 i-CON Calibration

You will need a suitable container to collect the product or seed when calibrating and an accurate set of scales which weighs in grams.

15.1 On the Machine

1. Fit the calibration hopper and feed block assembly.
2. Position a suitable collection tray directly underneath the calibration hopper to catch the product.
3. Place a few kilograms of seed in the hopper.

15.2 On the i-CON Instrument

1. Switch the fan off at the instrument
2. Switch the head unit ON via the left hand side push button – wait until the start-up routine has finished and displays the main “home screen”.
3. Scroll through  to the Setup Menu and select the Applicator Icon.
4. Adjust the implement width accordingly - refer to the RDS/Topcon manual, Set Implement Width.
5. Ensure the correct application rate is entered – select and adjust accordingly, refer to the RDS/Topcon manual, Setting the Application Rate.
6. Ensure the feed roller setup is appropriate for the intended product or seed type, application rate and forward speed range for application.
7. The instrument calculates the calibration factor from the working width, target application rate, and the metered weight delivered whilst calibrating. If however as a result of the calibration routine, you find that you cannot achieve your desired field speed, displayed in the top right corner of the screen, then re-configure the feed roll assembly and repeat the calibration procedure.
8. Prime the feed rolls with product by pressing and holding briefly the prime button on the junction box - this will ensure a higher initial calibration accuracy, empty the contents of the tray back into the hopper.
9. For an **Auto Calibration** from the Product Setup page, press .
10. Touch  and enter the quantity that you wish to dispense for calibration purposes. You can enter the quantity in grams if preferred. The CAL factor will however, still be calculated in kg/rev.
11. Touch on the screen page .
12. After the  key the motor runs at the calibration speed (calculated from the Simulated Forward Speed, Width, Application Rate and current calibration factor).
13. The dispensed weight (based on the current calibration factor) is displayed.
14. Weigh the product dispensed and then enter the measured weight, and press .

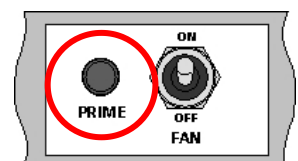
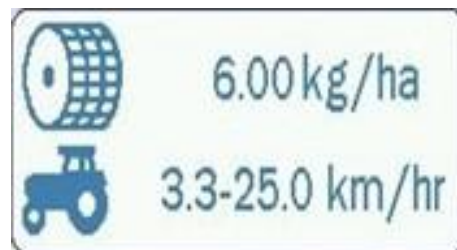

15. A new calibration factor is then re-calculated and displayed.

16. Your in-field min and max speeds will be displayed as per the image opposite. If you find that you cannot achieve your desired field speed, then re-configure the feed roll assembly and repeat the calibration procedure. **NOTE:** Recommended min speed 0.8kph - 1.2kph (if not see feed roller configuration).

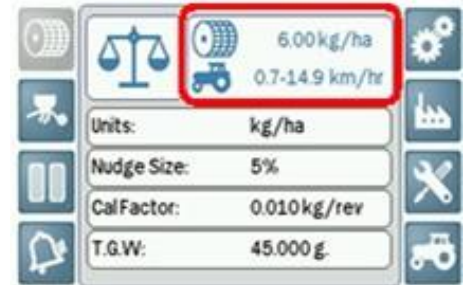

17. Touch  to save the new factor. It is advised to repeat the calibration two more times to ensure accuracy.

15.3 Manual Calibration

1. For a manual calibration press and hold the prime button on the junction box, the larger the quantity dispersed the higher the accuracy the final calibration factor will be, release the prime button once sufficient product has been dispensed. The estimated dispensed weight based on the current calibration factor is displayed.



2. Weigh the product dispensed in grams and then enter the measured weight, and press .

3. A new calibration factor is then re-calculated and displayed.

4. Your in-field min and max speeds will be displayed. If you find that you cannot achieve your desired field speed, then re-configure the feed roll assembly and repeat the calibration procedure.

5. Touch  to save the new factor, it is advised to repeat calibration two or three more times to ensure accuracy.

15.4 GPS Speed

The i-CON control system is automatically configured to run with the GPS receiver supplied and is a simple plug and play device. This system only works outside and if you are not receiving a GPS signal an alarm will display on the main screen indicating NO GPS.

15.5 Common Calibration Mistakes

- Ensure you enter the width and required rate correctly – that the decimal point is in the correct position. If the rate is 2.5 kg/ha, enter 2.5 not 25 - which is 25kg/ha.
- Remember to deduct the weight of the collection bag or bucket – weigh only the contents.
- Ensure you work in grams – not kilograms.
- Ensure you are working in the mode required – either Kilograms per Hectare or Seeds per Square Metre. The standard default mode for the i-CON is in kgs/ha and you will have to reconfigure the display if you want to display Seeds per Square Metre. You do not need to enter or change the TGW if working in Kgs/Ha – only if working in Seeds per Square Metre - Refer to the RDS manual.
- Ensure you check the minimum and maximum speeds displayed, and that they are sensible for your field operation. This is the speed range that the i-CON can maintain the required application rate, and depends on the width of your machine, the application rate required, and the type and configuration of feed rolls fitted.
- Ensure that the speed range will work for you in the field – ensure that your target forward speed will not be close to either the minimum or the maximum of the range, and that you have some reserve of speed range above and below the in-field forward speed. Ideally your forward speed will be in close to the middle of the range.
- If the minimum is too high, for example 4kph then the feed motor will be running too slowly if your forward speed drops towards the minimum as you set in and lift out of work, and this could result in missed patches although the alarm will trigger when either the minimum or maximum speed is reached.
- If the indicated speed range does not work for your operation, you must change the feed roll configuration or the type of feed roll to apply more or less seed, per revolution of the feed mechanism, as required. Once completed, recalibrate and note the new speed range.

15.6 Ready For Work

Ensure the feed motor is running.

Ensure the fan switch is on.

Check all outlet pipes are seeding correctly before commencing work.

15.7 Setting the Feed Rate

The feed rate is adjusted by the feed motor speed and by fitting different feed roller combinations. Each combination gives different feed rates of material per revolution. Refer to the Calibration Procedure and with the appropriate feed rollers fitted, follow the instructions. You may have to change the feed rollers to obtain the application rate within a sensible forward speed range, which is calculated during the calibration procedure.

15.8 Run Hold/Cut Out Switch

This optional switch can be mounted in a suitable place on the implement or linkage on the tractor. Deflecting the spring and automatically switching the feed motor off or on accordingly as the circuit is made or broken.



Part No: 47TJT50025

Position the optional finger switch so that the tip of the spring comes into contact with the moving part of the implement or linkage when lifted out of work and remains deflected until the implement is lowered back into work.

NOTE: Ensure that there is sufficient and positive deflection on the spring to prevent accidental switching ON or OFF if the implement moves slightly up or down in work. The standard wiring supplied for this switch is when the spring is at rest, the feed motor will run normally.

15.9 Hopper Level Sensor

There is an optional hopper level sensor available. This option is useful when the hopper of the applicator is out of view of the operator. The alarm will sound once the product in hopper drops below the level of the sensor.

For more information please contact your local Stocks Ag dealer.



Hopper level sensor - Part No: 47TJT5037

16.0 Feed Block Kit Information

⚠ WARNING! Moving parts of this machine are powerful and can cause injury. Be especially careful whilst performing calibration tests. Always observe all application standards and guidelines provided by the product manufacturer as some seed dressings and granular products may be toxic.

If unsure contact your seed or product supplier for more information.

NOTE: Before applying very fine seeds or product please contact your local dealer or Stocks Ag directly to ensure the machine is suitable. Failure to do so could invalidate your warranty.

16.1 Standard Large Seed Feed Block Kit – 50mm

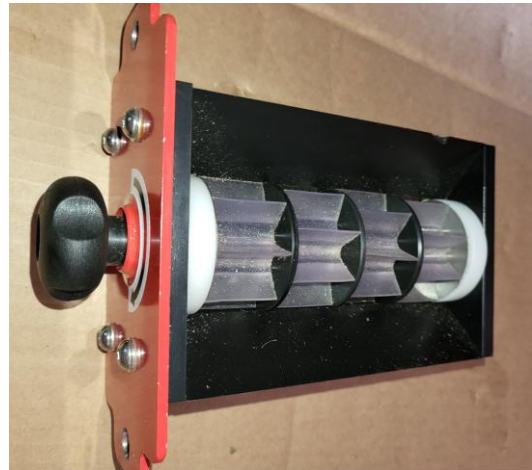
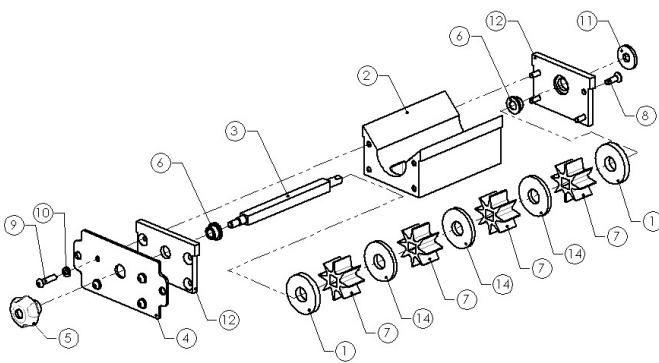

Part Number: 47RME5025

Supplied from factory with 8 or 10 feed rollers (1 feed roller per outlet) for grass seed and cover crop applications typically applied at rates up to 35kg/ha.

16.2 High Capacity Feed Block Kit – 59mm

When extra volume output is required above the standard 50mm large seed feed block. The Rotor Jet can be fitted with the 59mm diameter high capacity roller. This feed block is suitable for low weight, high volume products when installed in the Rotor Jet.

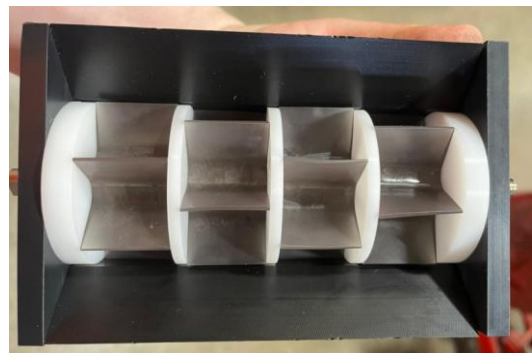
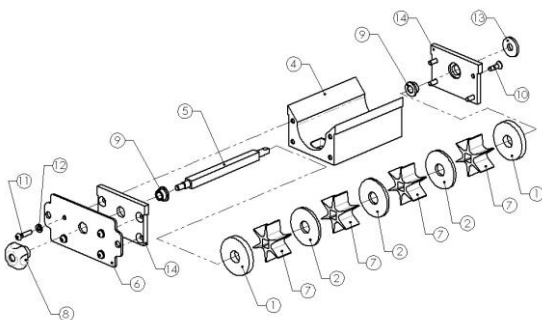

Part Number: 47RME5026

WARNING! It is the responsibility of the operator to ensure the feed block assembly is suitable for the product being applied.

16.3 Precision Small Seed Feed Block Kit

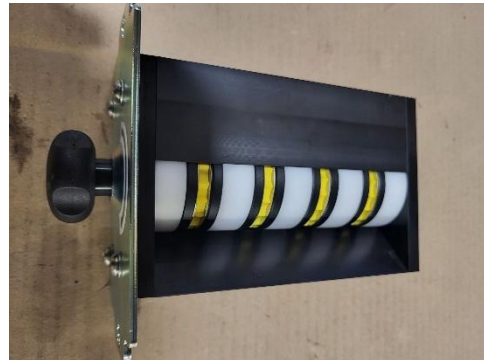
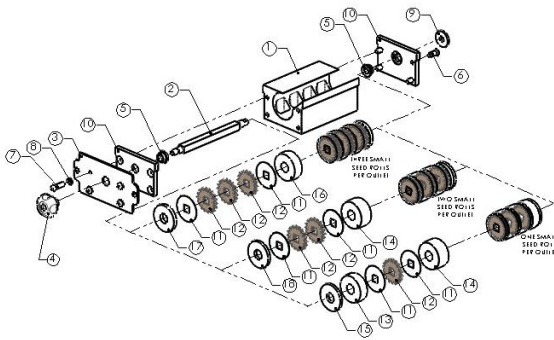

Part Number: 47RME5027

This block has been developed to eliminate finer products from leaking around the feed rollers and into the airstream. It is required for low rate work such as small seed and slug pellet application.

Yellow feed rollers are fitted from factory and typically used for small seed application such as OSR (Canola) with 1 feed roller fitted over each outlet as shown above. If higher rates are required the **white** feed rollers, also supplied in the kit, can be fitted to increase output.

NOTE: Yellow feed rollers apply approximately 40% less than the white rollers - product dependent.

If you cannot achieve the required rate using just a single yellow or white roll, then use multiple rolls together per outlet, for example 2 or 3. You can also mix the yellow and white provided each outlet has the same configuration of feed rolls. Other components from this kit, which include 16 white feed rollers and 3 black 5mm blanking spacers can be found in a bag packed inside the hopper.

NOTE: Before applying very fine seeds or product please contact your local dealer or Stocks Ag direct to ensure the machine is suitable. Failure to do so could invalidate your warranty.

The feed rollers are easily changed by removing the feed mechanism as follows:

1. Ensure the hopper is completely empty.
2. Undo and remove the 2 black plastic knobs holding the mechanism in place and slide out the feed block.
3. Undo and remove the 4 socket head screws on the end of the housing and remove the end plate. Slide the feed rollers and spacers off the shaft and replace with the alternative rollers required.

The black blanking spacers (3 supplied) are the same width as the small seed rolls and are used in combination with the feed rolls to allow 1, 2 or 3 feed rolls per outlet to be used or to replace the feed rolls and blank off an outlet completely. For example, if reducing the number of outlets from 8 to 7, to correspond with subsoiler legs or tines, remove all the feed rollers from that outlet and replace with a 5mm blanking spacer.

NOTE: When re-fitting the end plate to the feed block after changing the feed roller configuration, the end plate should be able to fit flush with the feed block by hand, without having to pull it home with the socket head screws. The assembled rolls and spacers should not be under compression. Once re-assembled, slide the feed block assembly back into the machine ensuring the drive shaft engages correctly by slowly rotating the feed shaft. Once engaged secure the two black plastic retaining knobs.

⚠ WARNING! It is the responsibility of the operator to ensure the feed block assembly is suitable for the product being applied.

16.4 Granular Feed Kit

Designed for fine granules at higher application rates such as Avadex®* Excel 15G at 15kg/ha and can also be used for fine seed work where high outputs are required.

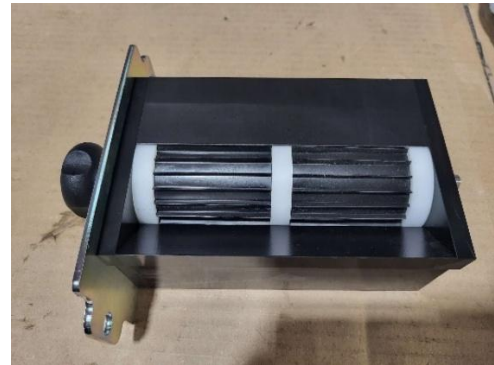
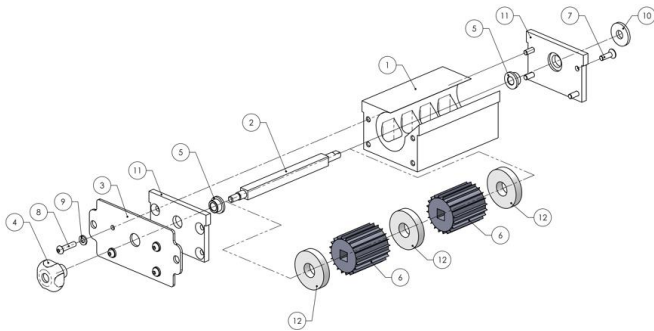

Part Number: 47RME5030

NOTE: If replacing the feed rollers always ensure the outer two rollers are positioned so that the blank end of the feed roller faces each of the PVC end plates.

Avadex ®* is a Trademark used under licence by Gowan Crop Protection Ltd.

WARNING! It is the responsibility of the operator to ensure the feed block assembly is suitable for the product being applied.

NOTE: Before applying very fine seeds or product please contact your local dealer or Stocks Ag directly to ensure the machine is suitable. Failure to do so could invalidate your warranty.

17.0 Ready for Work

Once calibrated your machine is ready for work

1. Remove the calibration tray and store away safely.
2. Re-fit and secure the calibration cover on the bottom of the outlet manifold.
3. Check all outlet pipes are seeding correctly.
4. Ensure that you are travelling at the correct chosen speed if not using the optional GPS Kit.
5. Stop after a few metres – check for even distribution, spread and application rate.
6. Commence work checking periodically to ensure the machine is working correctly.

If you are unable to calibrate correctly or you have any other questions about the machine please contact us.

CAUTION. The feed rolls and agitator can pull in hair or loose clothing. The motor is so powerful that you will be unable to stop it.

Always clean out the machine at the end of the day, use a brush not your hand to sweep out the hopper.

 **WARNING!** Always observe all application standards and guidelines provided by the product manufacturer as some seed dressings and granular products may be toxic.

NOTE: If unsure contact your seed or product supplier for more information.

18.0 i-CON Control System – Drawing and Parts

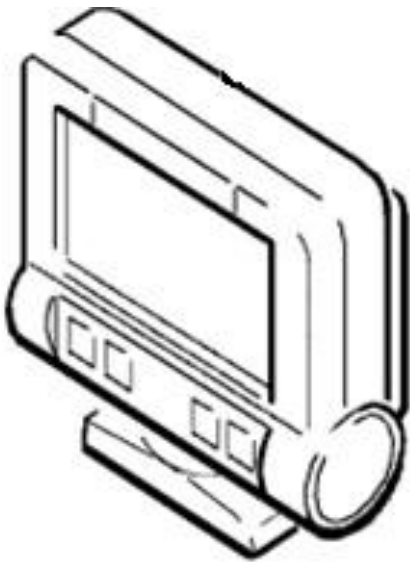

i-CON Control Box
Part number: TJ117C

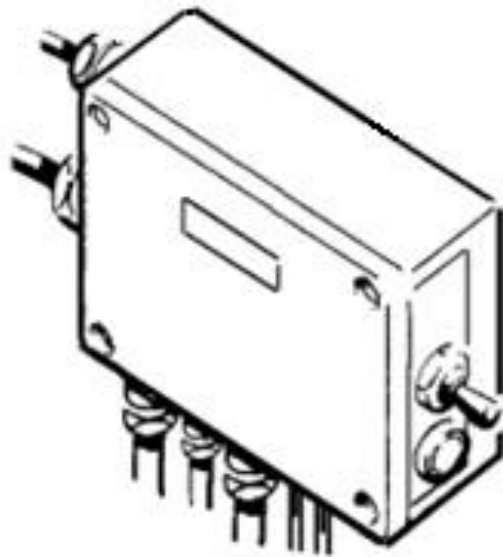

i-CON Junction Box
Part number: TJ119D

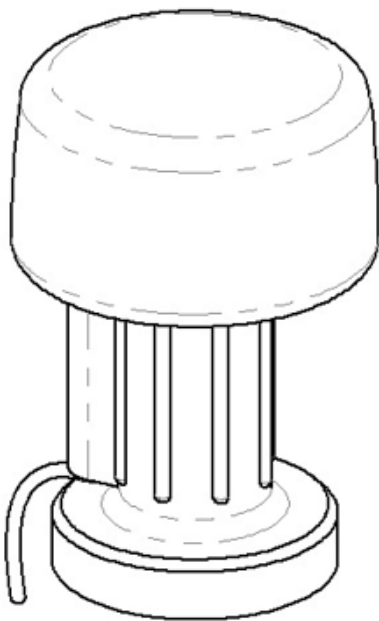

GPS Receiver
Part number: TJ255B

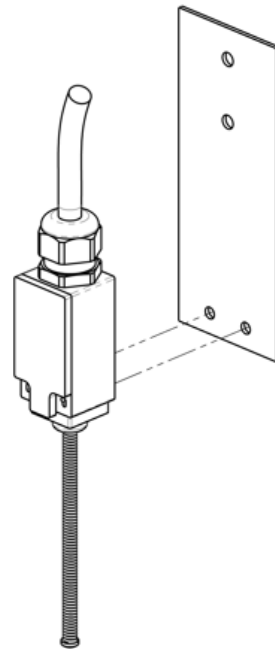

Finger Switch (Cut Out/Run Hold)
Part number: TJ252

5m Fused Power Cable
Part number TJ238 (No Image)

Finger Switch Mounting Plate Part Number: TJ253

Finger Switch Cable Part Number: TJ254

5m Instrument Cable
Part number TJ242A (No Image)

19.0 Rotor Jet 130 Parts Drawing

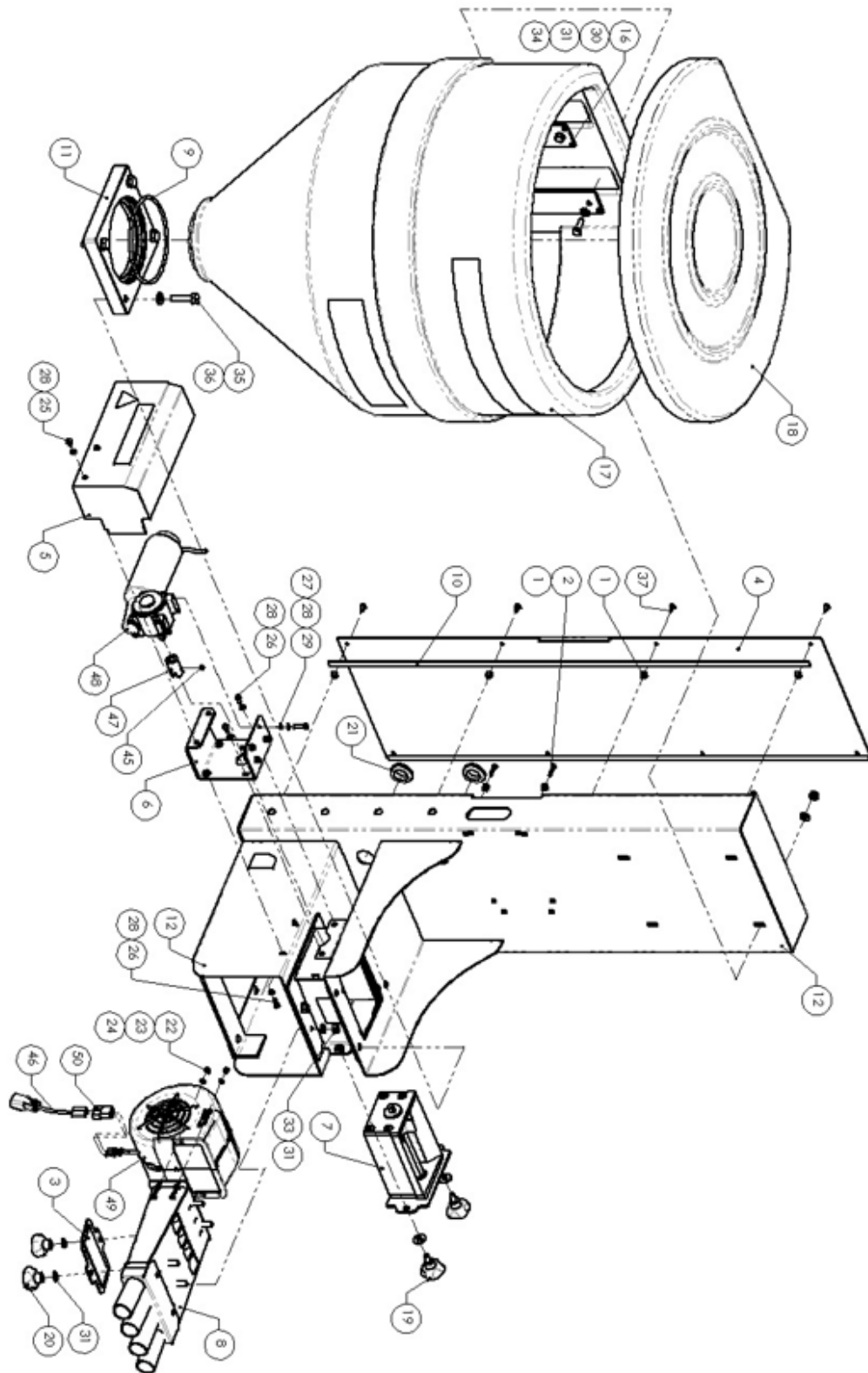

19.1 Rotor Jet 130 Parts List

ITEM No	PART No	DESCRIPTION	QTY
1	47RME5026	ROTOR JET HIGH OUTPUT 59.0mm DIAMETER FEED BLOCK KIT	1
2	89APP1011	JETPRESS CAN 015 SQUARE HEADED SCREW GROMMET	12
3	97APC4027	AIR CHAMBER DOOR WELD ASSEMBLY	1
4	97APC4029	BACK PLATE REAR COVER	1
5	97APC4034	DUNKER MOTOR GUARD WELD ASSEMBLY	1
6	97APC4038	DUNKER MOTOR BRACKET WELD ASSEMBLY	1
7	97APC4039	6mm WIDE x 3mm THICK CLOSED CELL SELF ADHESIVE TAPE	1
8	97APC4084	4 OUTLET AIR BOX WELD ASSEMBLY	1
9	97APC4086	5mm SECTION 140mm BORE O-RING NI 70	1
10	97APC4088	10.0 WIDE x 3.0 THICK SELF ADHESIVE FOAM STRIP (BLACK)	2
11	97APC4115	HOPPER BASE PLATE	1
12	97APC4230	CHASSIS WELD ASSEMBLY - 130L	1
13	98APP1025	STOCKS AG DECAL	1
14	98APP1051	ROTOR JET SERIAL No. UKCA CE	1
15	98APP1052	ROTOR JET DECAL	1
16	FJ005A	HOPPER BRACKET PLATE	2
17	FJ026B	130L HOPPER	1
18	FJ026B	DECAL - KEEP CLEAR	1
19	FJ027B	130L HOPPER LID	1
20	FJ032B	M8 X 15 PLASTIC KNOB - BLACK	2
21	FJ033A	M8 FEMALE PLASTIC KNOB - BLACK	2
22	GR005	GROMMET	3
23	M4-003	M4 x 10 HEX HEAD SET SCREW ST/ST	4
24	M4-004A	M4 NYLOC NUT T TYPE BZP	4
25	M4-006	M4 FLAT WASHER FORM A ST/ST	8
26	M4-011	M4 x 25 HEX SOC CAP HEAD SET SCREW ST/ST	4
27	M5-002	M5 x 12 SOC CAP HEAD SET SCREW ST/ST	4
28	M5-004	M5 x 12 HEX HEAD SET SCREW ST/ST	6
29	M5-014	M5 FLAT WASHER FORM A ST/ST	10
30	M5-019	M5 SPRING WASHER ST/ST	8
31	M8-006	M8 x 25 HEX HEAD SET SCREW SELF COLOUR	4
32	M8-010	M8 FLAT WASHER FORM A BZP	9
33	M8-017	M8 NYLOC NUT T TYPE ST/ST	4
34	M8-019	M8 NYLOC NUT T TYPE BZP	4
35	M10-009	M10 x 40 HEX HEAD SET SCREW BZP	4
36	M10-016	M10 FLAT WASHER FORM A BZP	4
37	M10-028	No. 10 x 13 POZI SELF TAPPING PAN HEAD SCREW ST ST	8
38	MD019	STOCKS QUALITY TICK DECAL	1
39	MD021	ROTATION ARROW DECAL	1
40	MD024	"MADE IN BRITAIN" DECAL	1
41	MD051	WARNING DECAL	1
42	MD051	WARNING DECAL	1
43	MD051	WARNING DECAL	1
44	MD051	WARNING DECAL	1
45	MM008A	M6 x 6 CUP POINT HEX SOCKET GRUB SCREW ST/ST	1
46	STO1138	MOTOR ADAPTOR LEAD	1
47	TJ043A	MOTOR DRIVE COUPLING - SLOTTED	1
48	TJ044B	12 Vdc FEED MOTOR	1
49	TJ120	CENTRIFUGAL SINGLE FAN UNIT	1
50	TJ122	2 WAY MALE CONNECTOR	1

20.0 Rotor Jet 240 Parts Drawing

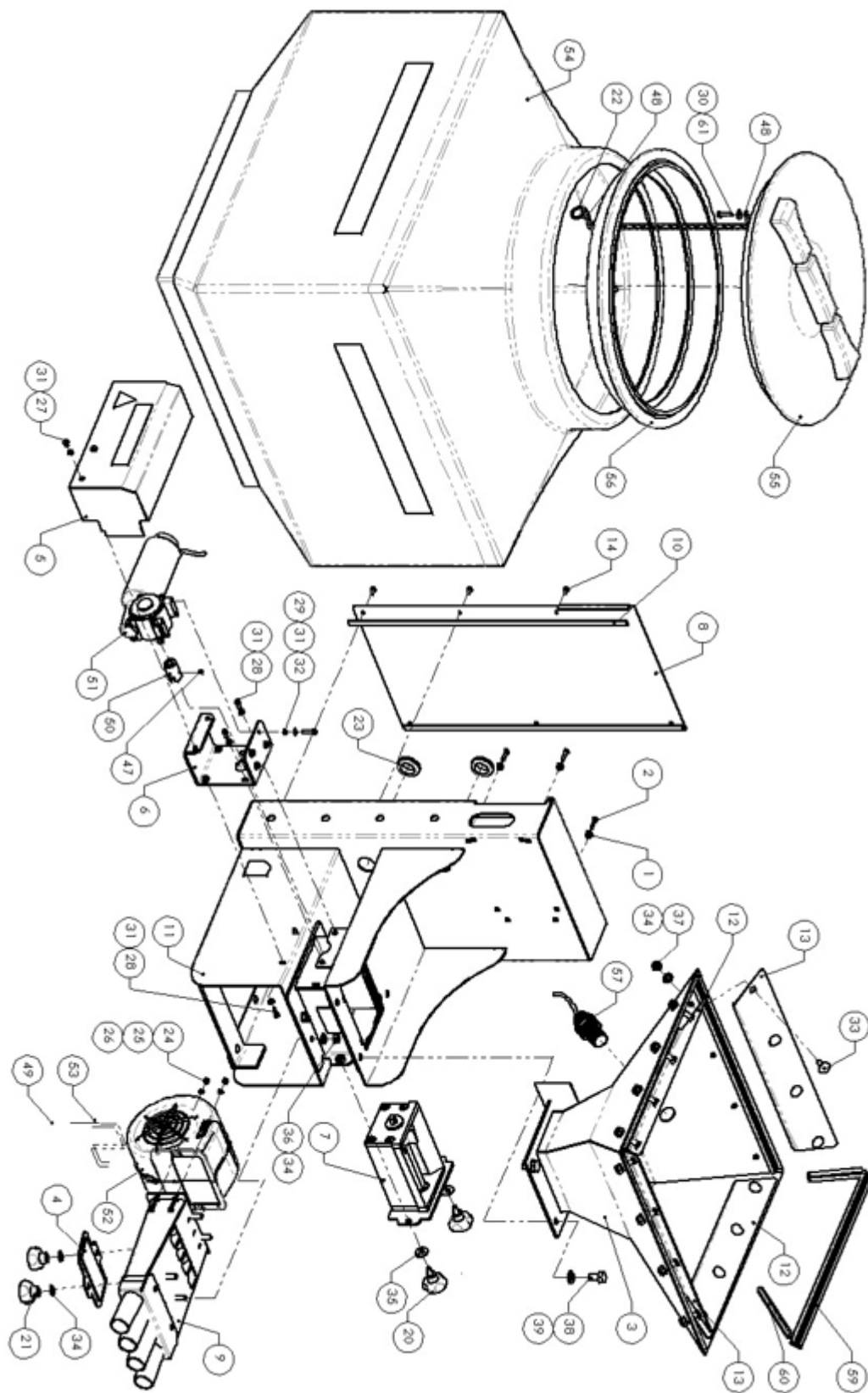

20.1 Rotor Jet 240 Parts List

ITEM No	PART No	DESCRIPTION	QTY
1	47RME5026	ROTOR JET HIGH OUTPUT 59.0mm DIAMETER FEED BLOCK KIT	1
2	89APP1011	JETPRESS CAN 015 SQUARE HEADED SCREW GROMMET	10
3	89APP1015	No. 8 HALF INCH POZI SELF TAPPING PAN HEAD SCREW ST-ST	6
4	97APC4025	HOPPER WELD ASSEMBLY	1
5	97APC4027	AIR CHAMBER DOOR WELD ASSEMBLY	1
6	97APC4034	DUNKER MOTOR GUARD WELD ASSEMBLY	1
7	97APC4038	DUNKER MOTOR BRACKET WELD ASSEMBLY	1
8	97APC4047	BACK PLATE REAR COVER	1
9	97APC4084	4 OUTLET AIR BOX WELD ASSEMBLY	1
10	97APC4088	10.0 WIDE x 3.0 THICK SELF ADHESIVE FOAM STRIP (BLACK)	2
11	97APC4240	CHASSIS WELD ASSEMBLY	1
12	97APC5178	HOPPER DOUBLER PLATE CASSETTE SIDE WELD ASSEMBLY	2
13	97APC5180	HOPPER DOUBLER PLATE FAN SIDE WELD ASSEMBLY	2
14	98APP1025	STOCKS Ag DECAL	1
15	98APP1025	STOCKS Ag DECAL	1
16	98APP1025	STOCKS Ag DECAL	2
17	98APP1051	ROTOR JET SERIAL No. UKCA CE	1
18	98APP1052	ROTOR JET DECAL - RED	2
19	FJ032B	M8 X 15 PLASTIC KNOB - BLACK	2
20	FJ033A	M8 FEMALE PLASTIC KNOB - BLACK	2
21	FJ418A	SPLIT RING	1
22	GR005	GROMMET	3
23	M4-003	M4 x 10 HEX HEAD SET SCREW ST/ST	4
24	M4-004A	M4 NYLOC NUT T TYPE BZP	4
25	M4-006	M4 FLAT WASHER FORM A ST/ST	8
26	M4-011	M4 x 25 HEX SOC CAP HEAD SET SCREW ST/ST	4
27	M5-002	M5 x 12 SOC CAP HEAD SET SCREW ST/ST	4
28	M5-004	M5 x 12 HEX HEAD SET SCREW ST/ST	6
29	M5-014	M5 FLAT WASHER FORM A ST/ST	10
30	M5-015	M5 REPAIR WASHER BZP	1
31	M5-019	M5 SPRING WASHER ST/ST	8
32	M8-010	M8 FLAT WASHER FORM A BZP	20
33	M8-019	M8 NYLOC NUT T TYPE BZP	20
34	M10-002	M10 x 20 HEX HEAD SET SCREW BZP	4
35	M10-016	M10 FLAT WASHER FORM A BZP	4
36	MD019	STOCKS QUALITY TICK DECAL	1
37	MD021	ROTATION ARROW DECAL	1
38	MD024	"MADE IN BRITAIN" DECAL	1
39	MD051	WARNING DECAL	1
40	MD051	WARNING DECAL	1
41	MD051	WARNING DECAL	1
42	MD051	WARNING DECAL	1
43	MD052	KEEP CLEAR DECAL	1
44	MM008A	M6 x 6 CUP POINT HEX SOCKET GRUB SCREW ST/ST	1
45	MM019	LOOP LINK CHAIN	1
46	STO1138	MOTOR ADAPTOR LEAD	1
47	TJ043A	MOTOR DRIVE COUPLING - SLOTTED	1
48	TJ044B	12 Vdc FEED MOTOR	1
49	TJ120	CENTRIFUGAL SINGLE FAN UNIT	1
50	TJ122	2 WAY MALE CONNECTOR	1
51	TJ126	240L SQUARE HOPPER	1
52	TJ128	LID	1
53	TJ129	NECK RING	1
54	TJ251A	HOPPER LEVEL SENSOR	1
55	TJ467-1	WHITE `P` SEAL STRIP	2
56	TJ467-1	WHITE `P` SEAL STRIP	2
57	TJ467-1	WHITE `P` SEAL STRIP	4
58	TJ1285	No.10 x 1 INCH HEX HEAD SELF TAPPING SCREW ST/ST	1

21.0 Granular Feed Roller - Parts

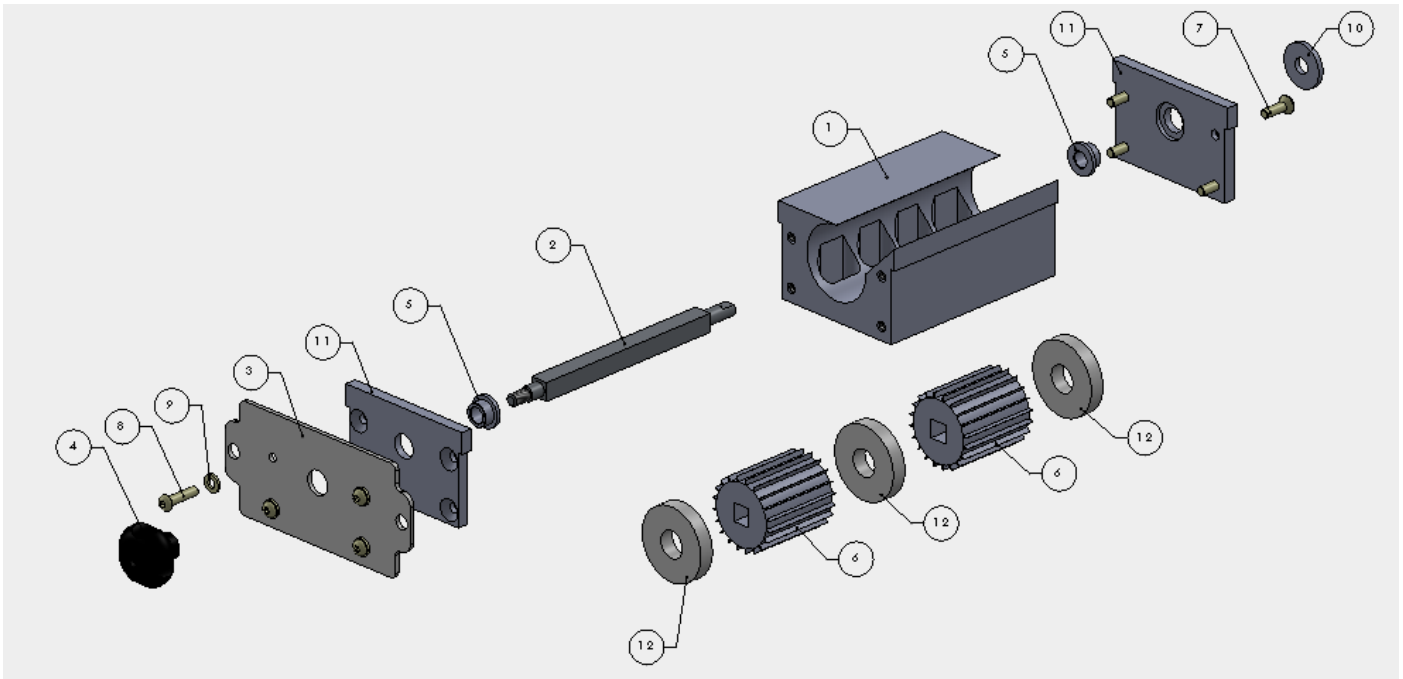

ITEM NO	PART NUMBER	DESCRIPTION	QTY
1	97APC4132	ROTOR JET PRECISION 4 OUTLET 50.8mm DIAMETER FEED BLOCK	1
2	97APC4133	SQUARE SHAFT	1
3	97APC4134	CASSETTE MOUNTING PLATE	1
4	FJ033A	M8 FEMALE PLASTIC KNOB - BLACK	1
5	GA103	FLANGED PVC BUSH	2
6	GA110	20 SECTION SMALL SEED ROLLER 28mm WIDE	2
7	M6-007	M6 x 20 CSK SOCKET HEAD SET SCREW ST/ST	4
8	M6-008	M6 x 25 HEX SOCKET BUTTON HEAD SET SCREW ST/ST	4
9	M6-016	M6 FLAT WASHER FORM A ST/ST	4
10	TJ033	WASHER GASKET	1
11	TJ101A	FEED END BLOCK PLATE	2
12	TJ208	10mm WIDE BLANKING SPACER	3

22.0 Precision (Small Seed) Feed Roller – Parts

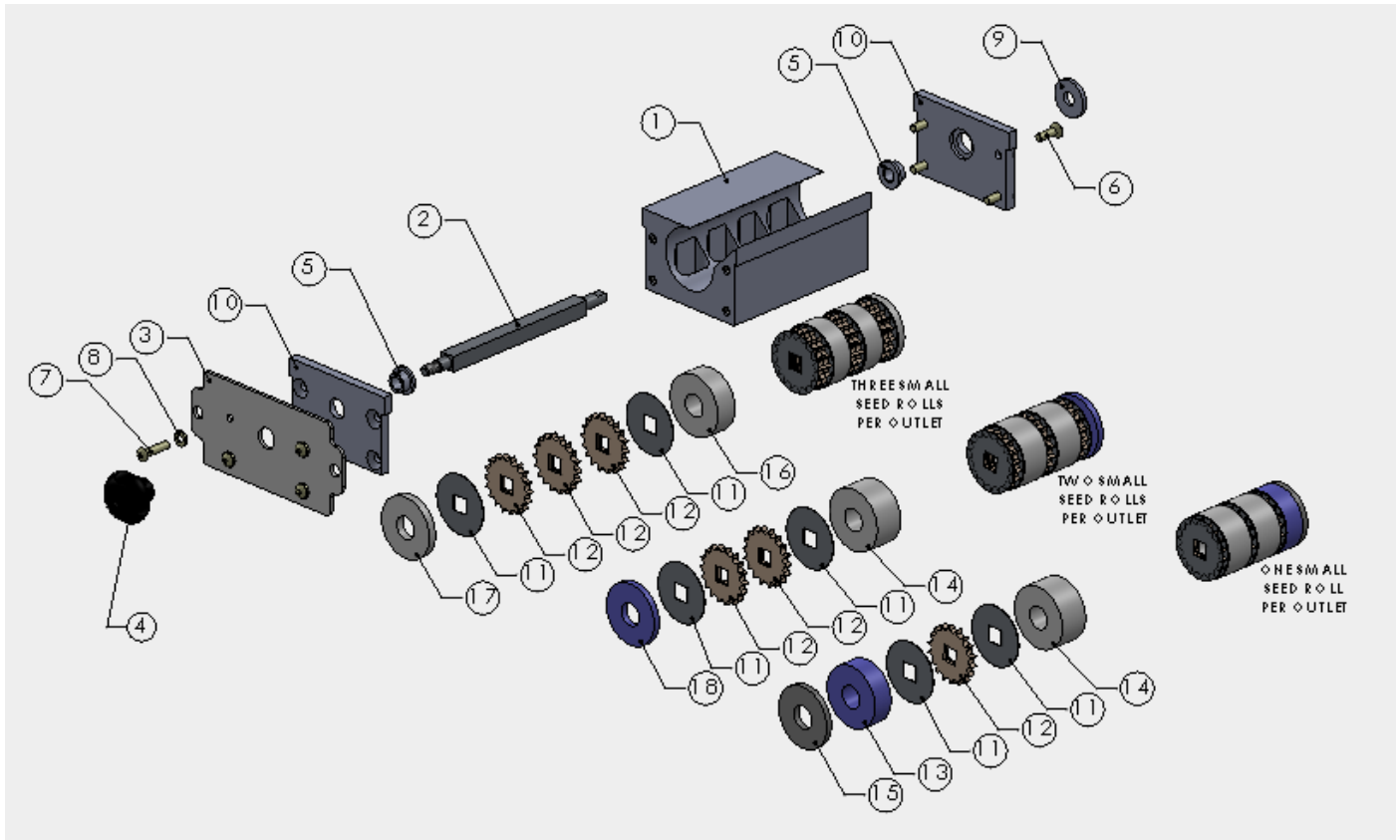

ITEM NO	PART NUMBER	DESCRIPTION	QTY
1	97APC4132	ROTOR JET PRECISION 4 OUTLET 50.8mm DIAMETER FEED BLOCK	1
2	97APC4133	SQUARE SHAFT	1
3	97APC4134	CASSETTE MOUNTING PLATE	1
4	FJ033A	M8 FEMALE PLASTIC KNOB - BLACK	1
5	GA103	FLANGED PVC BUSH	2
6	M6-007	M6 x 20 CSK SOCKET HEAD SET SCREW ST/ST	4
7	M6-008	M6 x 25 HEX SOCKET BUTTON HEAD SET SCREW ST/ST	4
8	M6-016	M6 FLAT WASHER FORM A ST/ST	4
9	TJ033	WASHER GASKET	1
10	TJ101A	FEED END BLOCK PLATE	2

23.0 Large Seed Feed Roller – Parts

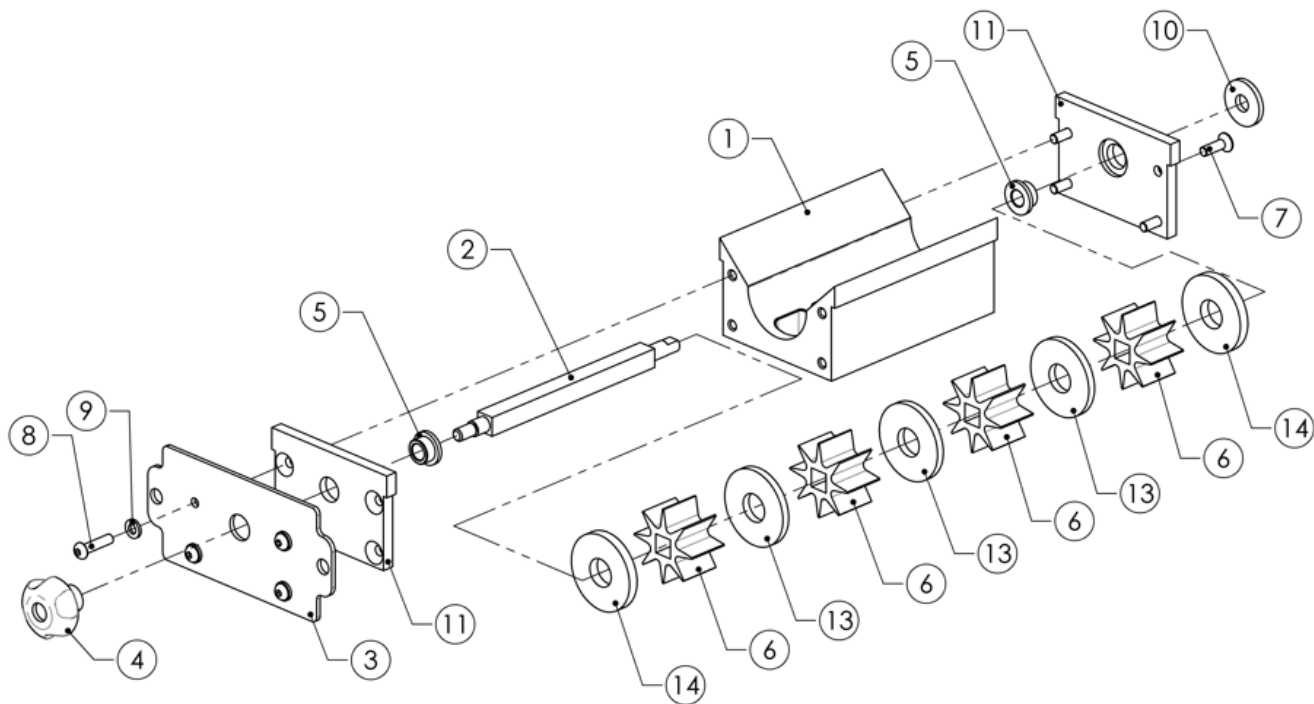

ITEM NO	PART NO	DESCRIPTION	QTY
1	97APC4130	FEED BLOCK 4 OUTLET 50.8mm DIAMETER	1
2	97APC4133	SQUARE SHAFT	1
3	97APC4134	CASSETTE MOUNTING PLATE	1
4	FJ033A	M8 FEMALE PLASTIC KNOB - BLACK	1
5	GA103	FLANGED PVC BUSH	2
6	GA110B-A	8 SECTION FEED ROLLER 28mm WIDE	4
7	M6-007	M6 x 20 CSK SOCKET HEAD SET SCREW ST/ST	4
8	M6-008	M6 x 25 HEX SOCKET BUTTON HEAD SET SCREW ST/ST	4
9	M6-016	M6 FLAT WASHER FORM A ST/ST	4
10	TJ033	WASHER GASKET	1
11	TJ101A	FEED END BLOCK PLATE	2
12	TJ204A	28.0 WIDE MID SPACER	1
13	TJ205	5mm WIDE BLANKING SPACER	3
14	TJ211	6.5mm WIDE BLANKING SPACER	2

24.0 High-Capacity Feed Block – Parts

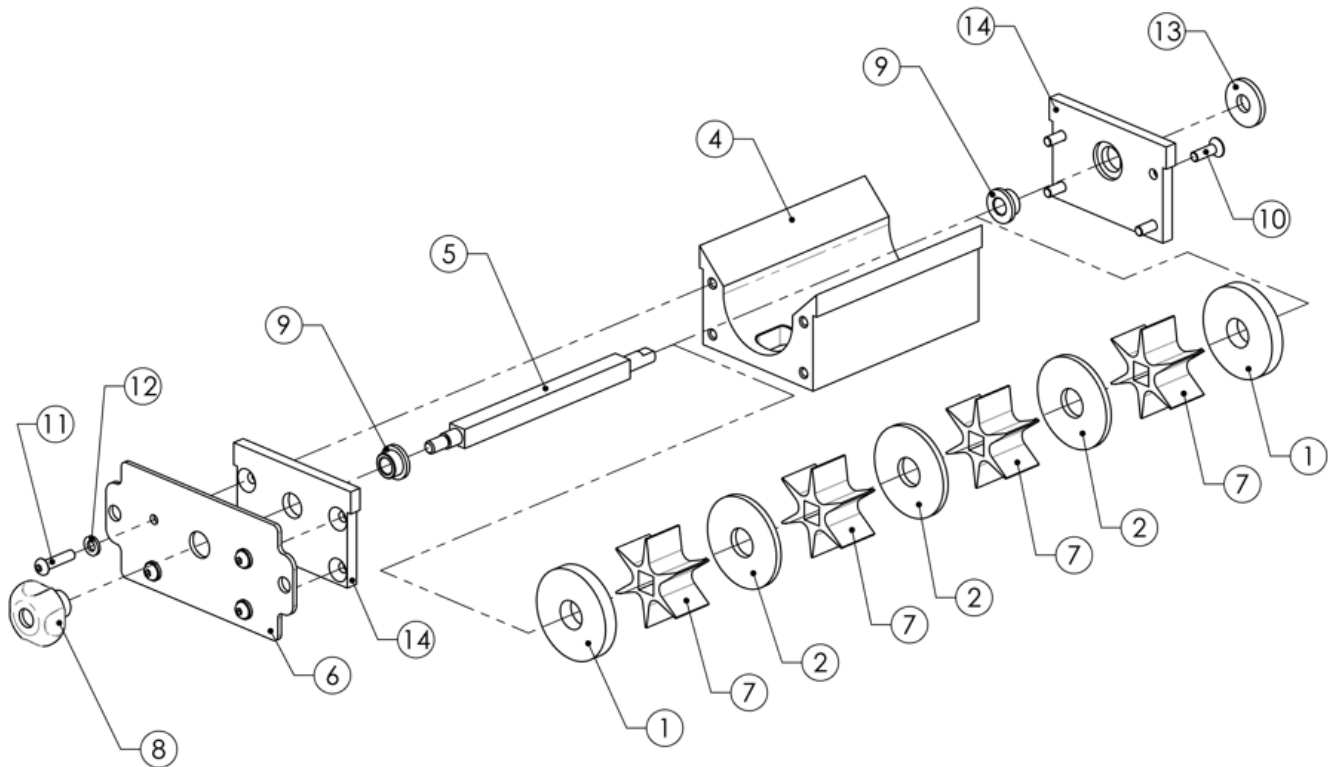

ITEM NO	PART NO	DESCRIPTION	QTY
1	97APC4054	9.0 WIDE SPACER - 59.0 OD	2
2	97APC4055	4.0 WIDE SPACER - 59.0 OD	3
3	97APC4056	28.0 WIDE SPACER - 59.0 OD	1
4	97APC4131	FEED BLOCK 4 OUTLET 59.0mm DIAMETER	1
5	97APC4133	SQUARE SHAFT	1
6	97APC4134	CASSETTE MOUNTING PLATE	1
7	97APC5196	59mm DIAMETER- 6 VANE - 28.0 WIDE FEED ROLLER	4
8	FJ033A	M8 FEMALE PLASTIC KNOB - BLACK	1
9	GA103	FLANGED PVC BUSH	2
10	M6-007	M6 x 20 CSK SOCKET HEAD SET SCREW ST/ST	4
11	M6-008	M6 x 25 HEX SOCKET BUTTON HEAD SET SCREW ST/ST	4
12	M6-016	M6 FLAT WASHER FORM A ST/ST	4
13	TJ033	WASHER GASKET	1
14	TJ101A	FEED END BLOCK PLATE	2

NOTES

[illegible]